

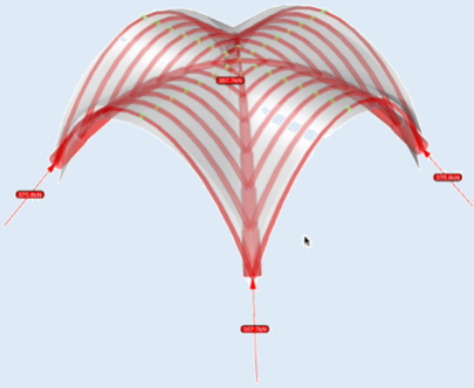

compas_tna

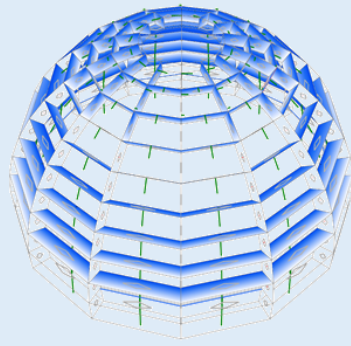

compas_rbe



compas_dem



compas_prd

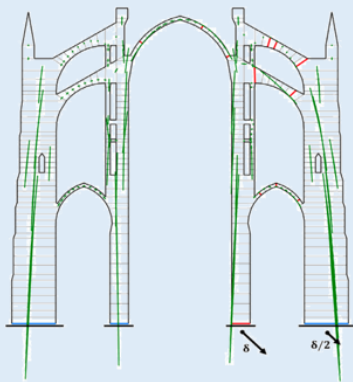

compas_tce

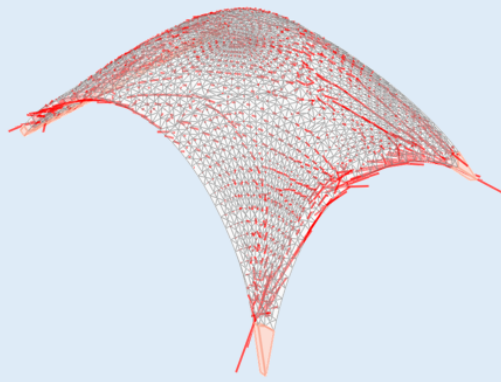

compas_cra

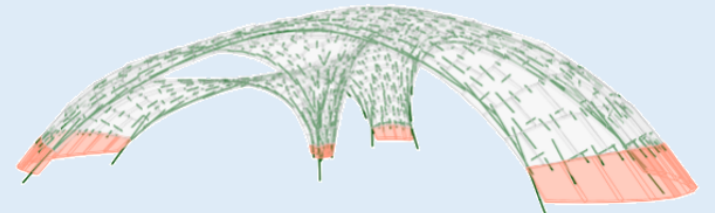

Getting Started

Tutorial →

A computational framework for the assessment of historic masonry constructions

IUSS / DA IDAUP lecture | March 9th 2022 | h 12:00

Aula C1 | Department of Architecture | Via Quartieri 8, Ferrara

The seminar will be given in mixed mode (on line and on site) - Interested readers are asked to send an email to mlv@unife.it

INTRODUCTION

VINCENZO MALLARDO

Full Professor | Department of Architecture UniFe

GUEST LECTURE

ANTONINO IANNUZZO

PhD | ETH Zurich, SWITZERLAND

Organized by | Prof. Vincenzo Mallardo

In collaboration with | International Doctorate Architecture and Urban Planning - IDAUP

Promoted by



Università degli Studi di Ferrara

IUSS Istituto Universitario di Studi Superiori IUSS-Ferrara 1391



Università degli Studi di Ferrara

DA

Dipartimento Architettura Ferrara



STU SLOVAK UNIVERSITY OF TECHNOLOGY IN BRATISLAVA

